



Technical Information

## Indoor modules MHX-II... and MHX-3... with 6 or 9 kW electric backup for OEnoviaPac heat pumps

# EN

### Maintenance – Product evolution

JS

N° ITOE0233-en

02/07/2020

## 1. Evolution

On the indoor modules with electric backup, the heater has been replaced by a heater connected directly to the terminal block without intermediate connector.

Production application date : **05/10/2018**.

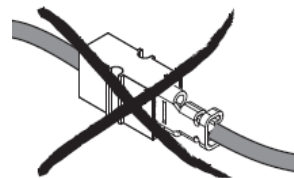

## 2. Spare parts

As the heater-wiring is not available as spare part, the entire heater must be replaced if necessary.

**WARNING: any work on the wiring is prohibited !**

**Reminder: Checking all electrical connections is part of the annual maintenance visit. The connections of the electric heater must also be checked in this context (check in particular for signs of overheating).**

References of the **6 kW and 9 kW heater kits**, available as **spare parts**:

Reference of the concerned appliances	Electric heater kits	Reference to order in spare parts	
<b>MHX-3/EM... :</b> 7609963, 7609964, 7609968, 7609969, 7609973, 7609974 <b>MHX-II/EM... :</b> 100016053, 100016054, 100017671, 100017672, 100018177, 100018178	6 kW		<b>7703468</b>
<b>MHX-3/ET...</b> 7609965, 7609970, 7609975 <b>MHX-II/ET... :</b> 100016055, 100017673, 100018179	9 kW		<b>7703469</b>

See next page: Leaflet **7703919-02** delivered with the electric heater kits ref. **7703468** and **7703469**.

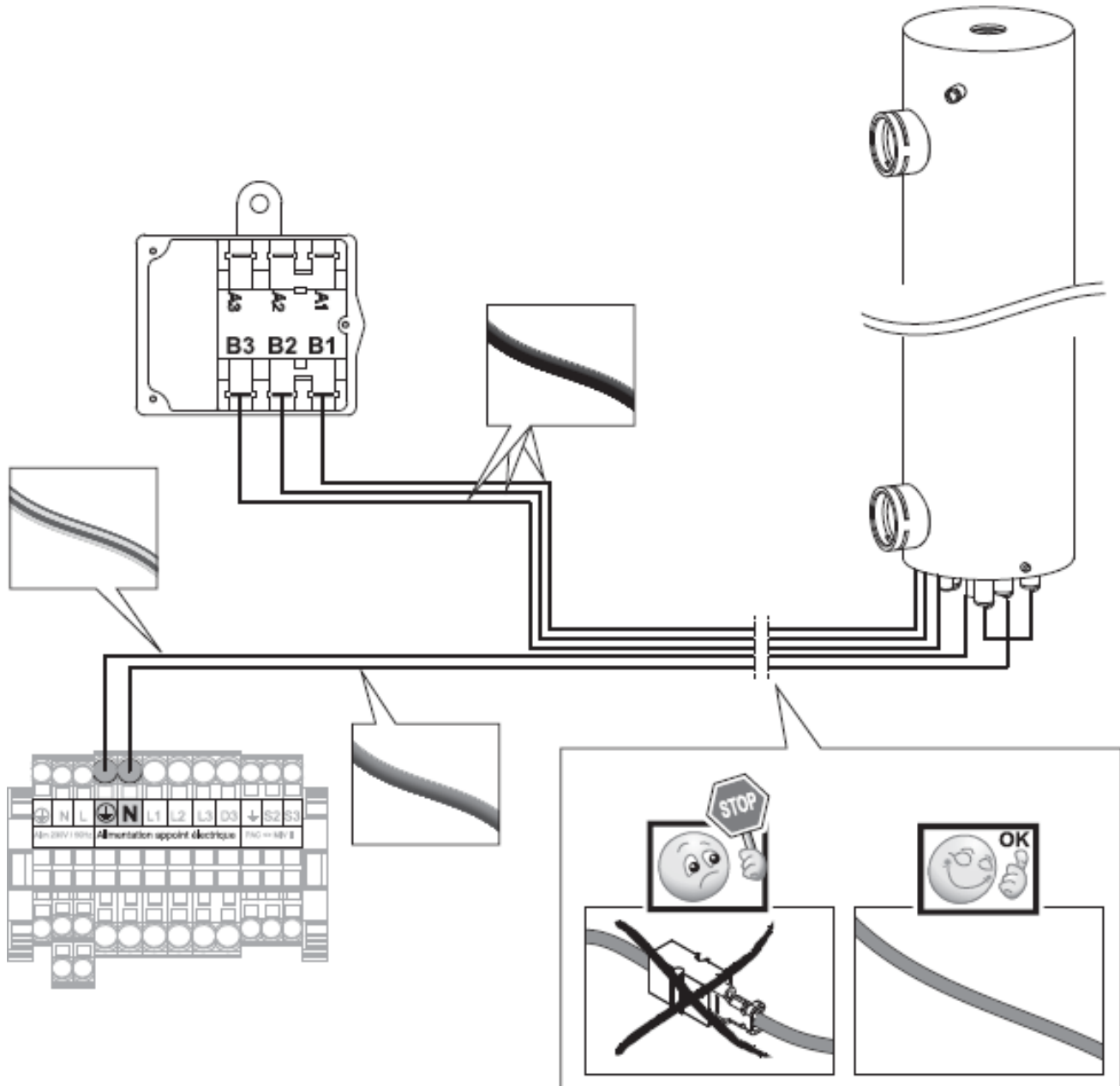
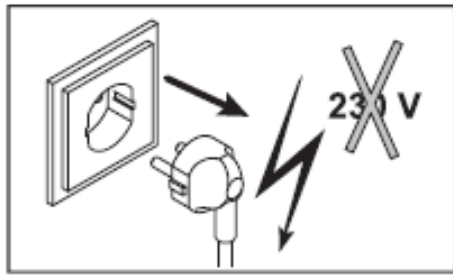

7703919-02

7703919-02